



INSTALLATION INSTRUCTIONS

Progress Technology Front Anti-Sway Bar

Mustang S550

Part # 61.0812

6-16-20 No Rev

WHO SHOULD INSTALL THIS PRODUCT?

Progress Technology products should only be installed by a qualified licensed mechanic experienced in the installation and removal of suspension components. Please read instructions from start to finish and verify the parts in the parts list before beginning installation.

Parts List

Description	Quantity
35mm Sway Bar	1
Bushings	2
U-bracket	2
Lube	1

1. Park vehicle on a smooth, level, asphalt or concrete surface. Block rear wheels. Jack up front end of car and support with jack stands or use a proper vehicle lift. Remove front wheels.
2. Remove the nuts that hold the end links to the sway bar on both sides. (Fig. A)

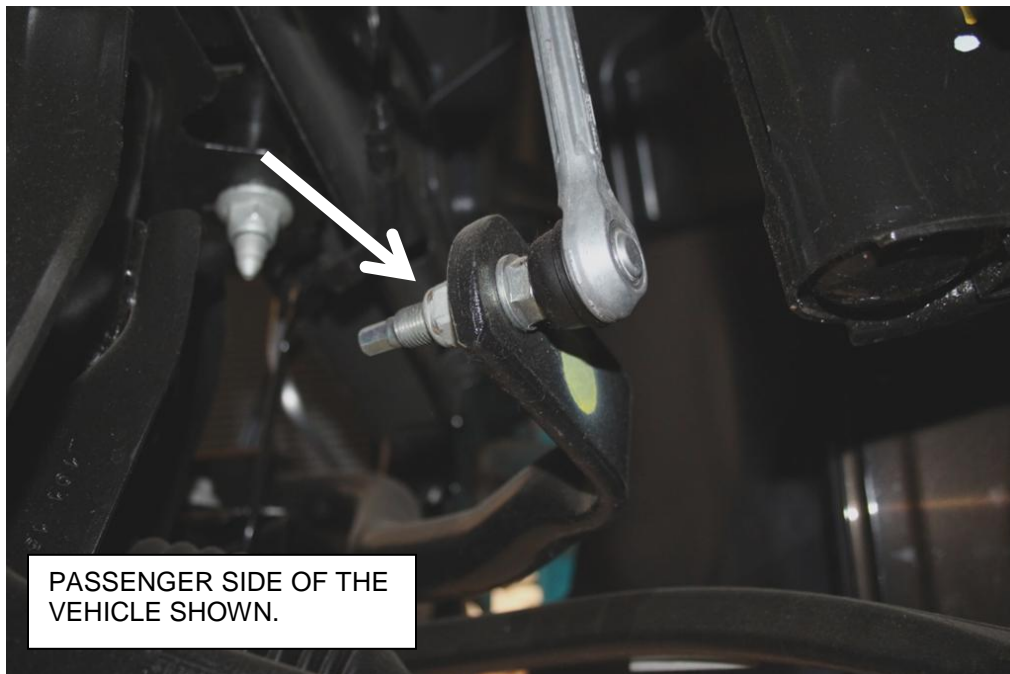

Figure A

3. Next, remove the factory hardware from the bushing brackets. (Tip) Remove the air box on the driver side of the engine compartment to gain access to these bolts. Remove the passenger side hardware using a long extension to reach the bolts. Turn the steering wheel to full lock and remove the OE sway bar from the vehicle. **Note how the bar comes out as you need to keep the same orientation for installing the PROGRESS sway bar.** (Fig. B)

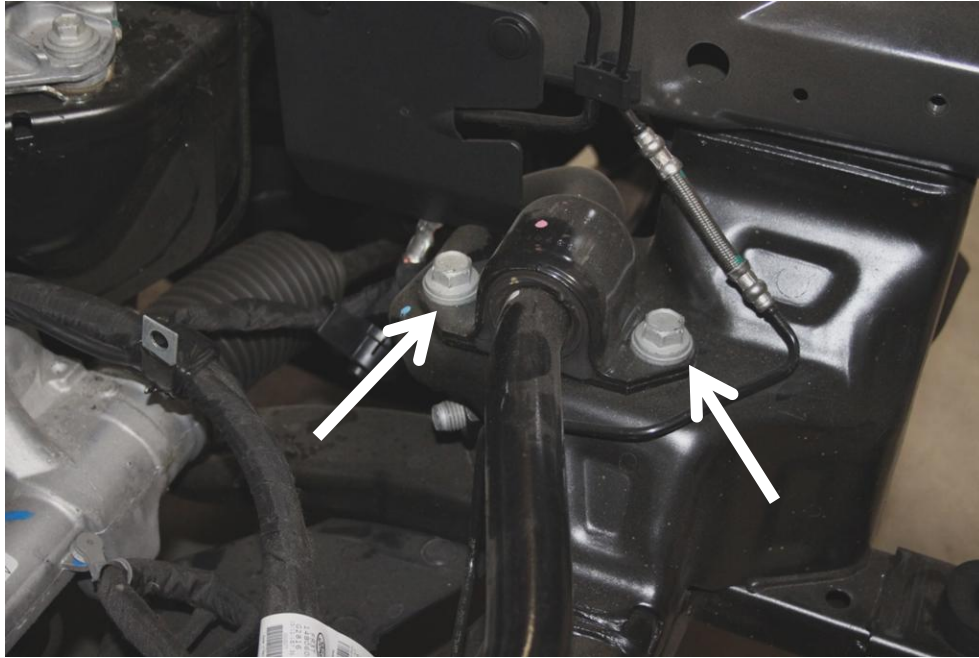

Figure B

4. Locate the pivot “D shaped” polyurethane bushings and tube of special grease supplied in the hardware kit. Cut the end off the grease tube and apply the grease to the bore of the polyurethane bushings (Fig. C) Open the bushings and snap them over the PROGRESS front sway bar, as positioned on the stock bar.

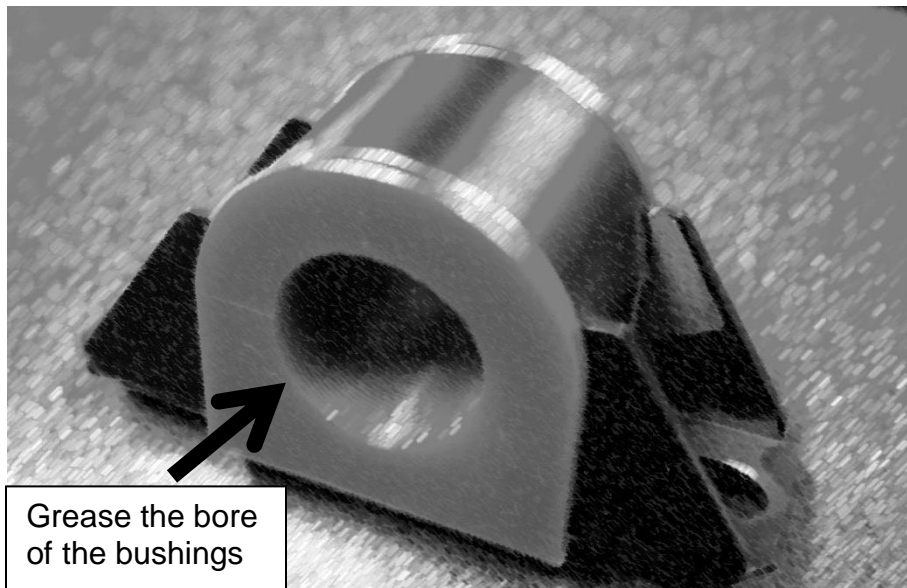

Figure C

5. Install the PROGRESS sway bar. Place the new brackets (supplied) over the pivot bushings. Torque the hardware to 50-52 ft/lbs.

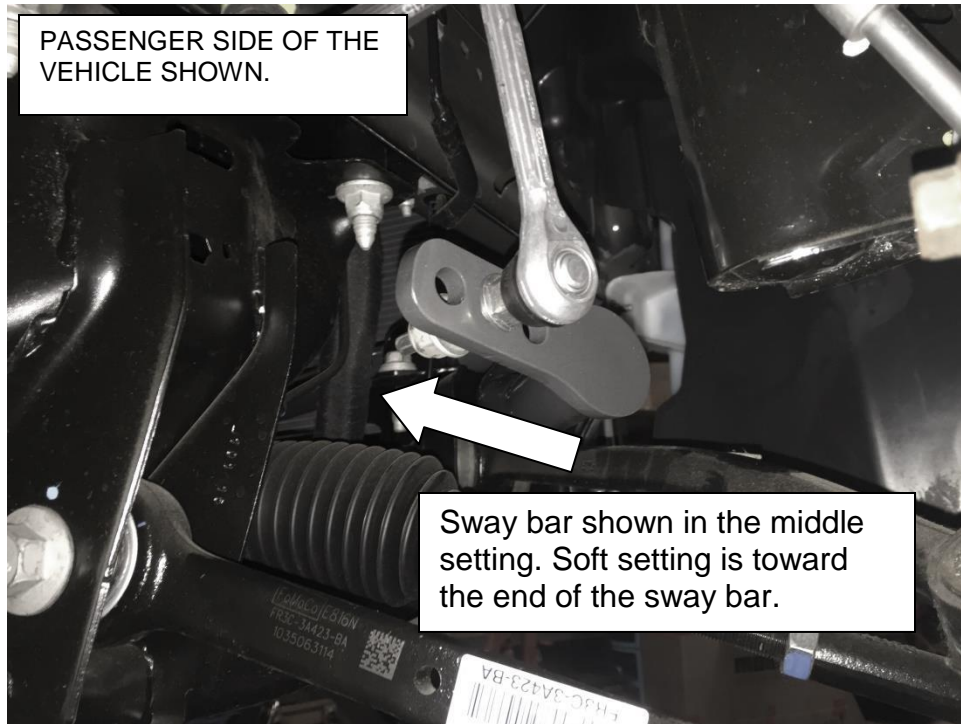

Figure D

6. Choose the setting on the sway bar. Torque the end link to 46-48 ft/lbs (Fig. D)

IMPORTANT NOTE ABOUT ADJUSTABLE SETTINGS:

We strongly suggest that your technician initially sets the end links in the softest setting. The softest setting will be the setting with the end links closest to the end or tip of the sway bar, furthest from the mounting bushings.

After installing the sway bar, we suggest that you drive the car carefully and within your abilities, noticing the changes in the handling characteristics. If driving in poor weather, exercise additional care during cornering and braking until you are familiar with the handling.

If you chose to use the firmer settings, again remember to drive the vehicle carefully, and take note of the changes you have made to the suspension. You will notice a handling difference with each sway bar settings.

7. Installation is complete. Check assembly periodically for tightness.

Torque Check

Hardware	Torque
End link nut	46-48 ft/lbs
Bushing bracket hardware	50-52 ft/lbs